

Kenton C. Ward, CFM
Surveyor of Hamilton County
Phone (317) 776-8495
Fax (317) 776-9628

Suite 188
One Hamilton County Square
Noblesville, Indiana 46060-2230

October 17, 2007

TO: Hamilton County Drainage Board

RE: Stultz & Almond Drain, Lakeside Park Section 5 Arm

Attached is a petition filed by Roehling Enterprises, Inc. along with a non-enforcement request, plans, calculations, quantity summary and assessment roll for the Lakeside Park Section 5 Arm, Stultz & Almond Drain to be located in Clay Township. I have reviewed the submittals and petition and have found each to be in proper form.

I have made a personal inspection of the land described in the petition. Upon doing so, I believe that the drain is practicable, will improve the public health, benefit a public highway, and be of public utility and that the costs, damages and expenses of the proposed drain will probably be less than the benefits accruing to the owners of land likely to be benefited. The drain will consist of the following:

6" SSD 909 ft.

The total length of the drain will be 909 feet.

The SSD is parallel to Towne Road and 141st Street. It runs 630 feet west from Str. 105 of the Stultz & Almond Drain, and 279 feet east and south from the same structure.

The petitioner has submitted surety for the proposed drain at this time. The sureties which are in the form of a Letter of Credit are as follows:

Agent: Huntington National Bank
Date: June 18, 2007
Number: OSB.004528
For: Storm Drains
Amount: \$120,820.00

Parcels assessed for this drain may be assessed for the Osborn & Collins or Williams Creek Drain at sometime in the future.

I believe this proposed drain meets the requirements for Urban Drain Classification as set out in IC 36-9-27-67 to 69. Therefore, this drain shall be designated as an Urban Drain.

The easement for this drain shall be the easement of the Stultz & Almond Drain shown on the secondary plat for Lakeside Park Section 5 as recorded in the office of the Hamilton County Recorder.

I recommend the Board set a hearing for this proposed drain for November 26, 2007.



Kenton C. Ward, CFM
Hamilton County Surveyor

KCW/pll

(Revised 06/08/04)

STATE OF INDIANA)
)
COUNTY OF HAMILTON)

FILED

SEP 05 2006

TO: HAMILTON COUNTY DRAINAGE BOARD

% Hamilton County Surveyor
One Hamilton County Square, Suite 188
Noblesville, IN. 46060-2230

OFFICE OF HAMILTON COUNTY SURVEYOR

In the matter of Lakeside Park Subdivision Subdivision, Section
 5 Drain Petition.

Petitioner is the owner of all lots in the land affected by the proposed new regulated drain. The drainage will affect various lots in Lakeside Park Subdivision, Section 5, a subdivision in Hamilton County, Indiana. The general route of such drainage shall be in existing easements and along public roads as shown in the plans on file in the Surveyor's Office.

Petitioner believes that the cost, damages and expenses of the proposed improvement will be less than the benefits which will result to the owners of the land likely to be benefited thereby. Petitioner believes the proposed improvements will:

- (a) improve public health
- (b) benefit a public street
- (c) be of public utility

Petitioner agrees to pay the cost of construction of the drainage system and requests periodic maintenance assessments by the Board thereafter.

The Petitioner also agrees to the following:

1. To provide the Drainage Board a Performance Bond or Non-Revocable Letter of Credit for the portion of the drainage system which will be made a regulated drain. The bond will be in the amount of 120% of the Engineer's estimate. The bond will be in effect until construction of 100% of the system is completed and so certified by the Engineer.
2. The Petitioner shall retain an Engineer throughout the construction phase. At completion of the project the Petitioner's Engineer shall certify that the drainage system which is to be maintained as a regulated drain has been constructed as per construction plans.
3. The Petitioner agrees to request in writing to the County Surveyor any changes from the approved plan and must receive written authorization from the County Surveyor prior to implementation of the change. All changes shall be documented and given to the Surveyor to be placed in the Drain file.
4. The Petitioner shall instruct his Engineer to provide a reproducible print on a 24" x 36" Mylar of the final design of the Drainage System. This shall be submitted to the County Surveyor prior to the release of the Performance Bond.
5. The Petitioner shall comply with the Erosion Control Plan as specified on the construction plans. Failure to comply with the Erosion Control Plan shall be determined by the Board as being an obstruction to the drainage system. The County Surveyor shall immediately install or repair the needed measures at Petitioners cost as per IC 36-9-27-46.

The Petitioner further requests that the Drain be classified as an Urban Drain as per IC 36-9-27-69(d).

RECORDED OWNER(S) OF LAND INVOLVED

Ray Roehling
Signed

Ray Roehling
Printed Name

September 1, 2006
Date

Signed

Printed Name

Date

Signed

Printed Name

Date

Signed

Printed Name

Date

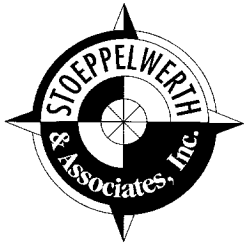

STOEPPELWERTH & ASSOCIATES, INC.

CONSULTING ENGINEERS • LAND SURVEYORS

David J. Stoeppelwerth
President, CEO
Professional Engineer
Professional Land Surveyor

Curtis C. Huff
Vice President, COO
Professional Land Surveyor

R.M. Stoeppelwerth
Founder
Professional Engineer
Professional Land Surveyor

June 8, 2007

Hamilton County Surveyor
One Hamilton County Square
Suite 188
Noblesville, Indiana 46060

Attention: Kent Ward

Re: Lakeside Park Subdivision, Section 5

Dear Mr. Ward:

Please accept the following Engineer's Estimate for Lakeside Park Subdivision, Section 5. The amounts are as follows:

Lakeside Park Subdivision, Section 5 Engineer's Estimate

Description	Quantity	Unit	Unit Price	Total
ON SITE STORM				
Storm Sewer 12" – 0-6Ft	318	LF	\$19.27	\$6,127.86
Storm Sewer 15" – 0-6Ft	266	LF	\$22.95	\$6,104.70
Storm Sewer 18" – 0-6Ft	577	LF	\$20.32	\$11,724.64
Storm Sewer 21" – 0-6Ft	395	LF	\$25.49	\$10,068.55
24 X 24 Box Structure	4	EA	\$1,450.00	\$5,800.00
48" Dia. Manhole – 0-6Ft	8	EA	\$1,412.75	\$11,302.00
Rip-Rap	40	TONS	\$45.00	\$1,800.00
12" End-Section	2	EA	\$500.00	\$1,000.00
18" End-Section W/TRASH				
GUARD	1	EA	\$975.00	\$975.00
21" End-Section	1	EA	\$650.00	\$650.00
6" Swale Drain	1,993	LF	\$8.50	\$16,940.50
6" Curb Drain	2,950	LF	\$8.50	\$25,075.00
4" Lateral Drain	26	EA	\$45.00	\$1,170.00

\$100,683.25

7965 East 106th Street
Fishers, Indiana
46038-2505

317.849.5935
Fax: 317.849.5942
www.Stoeppelwerth.com

Hamilton County Surveyor
Kent Ward
June 8, 2007
Page 2 of 2

Description	Quantity	Unit	Unit Price	Total
EROSION CONTROL				
Permanent Seeding	265,882	SQFT	\$0.13	\$34,564.66
R/W Seeding	82,950	SQFT	\$0.13	\$10,783.50
Silt Fence	6,180	LF	\$1.60	\$9,888.00
Temporary Pad Seeding	7.5	ACRE	\$388.57	\$2,913.83
Monuments and Markers	12	EA	\$150.00	\$1,800.00
Total				\$59,949.99

Total **\$160,633.24**

Witness my signature this 8th day of June, 2007.

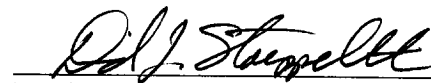

David J. Stoeppelwerth
Professional Engineer
No. 19358



S:\41760S5\Blue_Book\Agency_Correspondence\HamiltonCountySurveyorWardEE006-07-07.doc
EEF/jag

FINDINGS AND ORDER

CONCERNING THE MAINTENANCE OF THE

Stultz & Almond Drain, Lakeside Park Section 5 Arm

On this **26th day of November, 2007**, the Hamilton County Drainage Board has held a hearing on the Maintenance Report and Schedule of Assessments of the **Stultz & Almond Drain, Lakeside Park Section 5 Arm**.

Evidence has been heard. Objections were presented and considered. The Board then adopted the original/amended Schedule of Assessments. The Board now finds that the annual maintenance assessment will be less than the benefits to the landowners and issues this order declaring that this Maintenance Fund be established.

HAMILTON COUNTY DRAINAGE BOARD

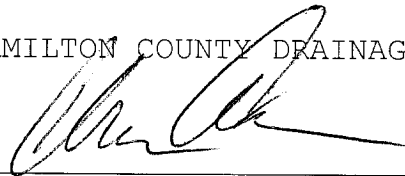

President

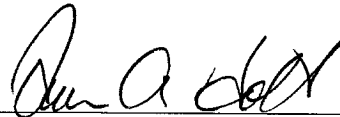

Member

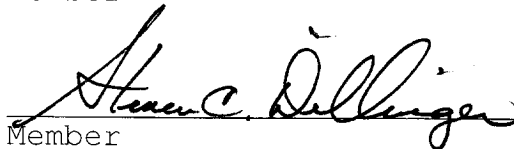

Member

Attest:

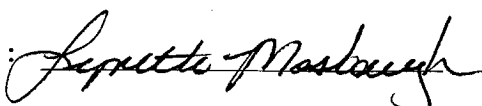

**Lakeside Park Section 5, 6, 7
GASB 34 Calculation**

Stultz & Almond Drain- Lakeside Park Section 5: 909 ft
Elliott Creek Drain-Lakeside Park Section 5: 5625

Total Footage = 6534.00
Bond Amount = \$160,633.24

Stultz & Almond Drain- Lakeside Park Section 5: $(.14 \times \$160,633.24) = \$22,488.66$
Elliott Creek Drain-Lakeside Park Section 5: $(.86 \times \$160,633.24) = \$138,144.58$

Stultz & Almond Drain- Lakeside Park Section 6: 1974 ft
Elliott Creek Drain-Lakeside Park Section 6: 650 ft
JW Brendle Drain-Lakeside Park Section 6: 1565 ft

Total Footage = 4189 ft
Bond Amount = \$141,969.35

Stultz & Almond Drain- Lakeside Park Section 6: $(.47 \times \$141,969.35) = \$66,725.59$
Elliott Creek Drain-Lakeside Park Section 6: $(.16 \times \$141,969.35) = \$22,715.10$
JW Brendle Drain-Lakeside Park Section 6: $(.37 \times \$141,969.35) = \$52,528.66$

Stultz & Almond Drain- Lakeside Park Section 7: 1800 ft
JW Brendle Drain-Lakeside Park Section 7: 3612 ft

Total Footage = 5412 ft
Bond Amount = \$101,677.21

Stultz & Almond Drain- Lakeside Park Section 7: $(.33 \times \$101,677.21) = \$33,553.48$
JW Brendle Drain-Lakeside Park Section 7: $(.67 \times \$101,677.21) = \$68,123.73$

Note: Bonds were posted at 120% of the engineers estimate. This dollar amount is based upon the engineer's estimate.

CERTIFICATE OF COMPLETION AND COMPLIANCE

To: Hamilton County Surveyor

Re: Lakeside Park Subdivision, Section 5

I hereby certify that:

1. I am a Registered Land Surveyor or Engineer in the State of Indiana.
2. I am familiar with the plans and specifications for the above referenced subdivision.
3. I have personally observed and supervised the completion of the drainage facilities for the above referenced subdivision.
4. The drainage facilities within the above referenced subdivision to the best of my knowledge, information and belief have been installed and completed in conformity with all plans and specifications.
5. The drainage facilities within the above referenced subdivision to the best of my knowledge, information and belief have been correctly represented on the Record Drawings, Digital Record Drawings and the Structure Data Spreadsheet.

Signature: _____

Date: November 16, 2007

Type or Print Name: Dennis D. Olmstead

Business Address: Stoepelwerth & Associates, Inc.

7965 East 106th Street, Fishers, Indiana 46038

Telephone Number: (317) 849-5935

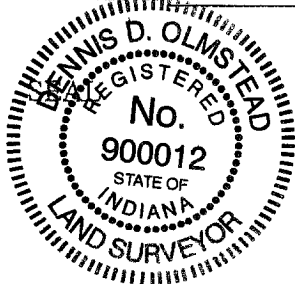

INDIANA REGISTRATION NUMBER

900012

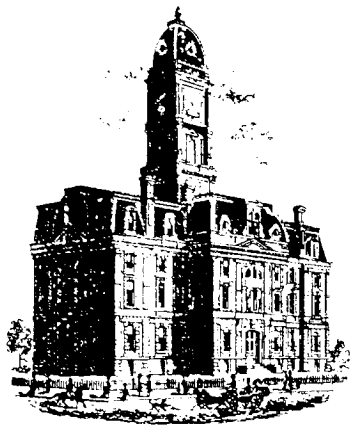

Kenton C. Ward, CFM
Surveyor of Hamilton County
Phone (317) 776-8495
Fax (317) 776-9628

Suite 188
One Hamilton County Square
Noblesville, Indiana 46060-2230

To: Hamilton County Drainage Board

September 23, 2008

Re: Stultz & Almond Drain: Lakeside Park Section 5

Attached are as-builts, certificate of completion & compliance, and other information for Lakeside Park Section 5. An inspection of the drainage facilities for this section has been made and the facilities were found to be complete and acceptable.

During construction, changes were made to the drain, which will alter the plans submitted with my report for this drain-dated October 17, 2007. The report was approved by the Board at the hearing held November 26, 2007. (See Drainage Board Minutes Book 10, Pages 498-499) The changes are as follows:

The 6" SSD was lengthened from 909 feet to 1385 feet.

The length of the drain due to the changes described above is now **1385 feet**.

The non-enforcement was approved by the Board at its meeting on November 26, 2007 and recorded under instrument #2007066458.

The following sureties were guaranteed by Huntington National Bank and released by the Board on its August 13, 2007 meeting.

Bond-LC No: OSB.004528
Insured For: Storm Sewers
Amount: \$120,820.00
Issue Date: June 18, 2007

I recommend the Board approve the drain's construction as complete and acceptable.

Sincerely,

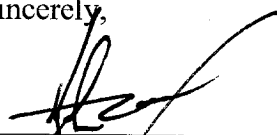

Kenton C. Ward, CFM
Hamilton County Surveyor

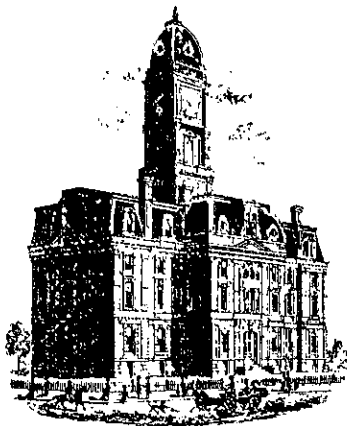

Kenton C. Ward, CFM
Surveyor of Hamilton County

Phone (317) 776-8495

Fax (317) 776-9628

Suite 188

One Hamilton County Square
Noblesville, Indiana 46060-2230

To: **Hamilton County Drainage Board**

October 7, 2009

**Re: Stultz & Almond Drain: Lakeside Park Section 5
(Revised Final Report)**

Attached are as-builts, certificate of completion & compliance, and other information for Lakeside Park Section 5. An inspection of the drainage facilities for this section has been made and the facilities were found to be complete and acceptable.

During construction, changes were made to the drain, which will alter the plans submitted with my report for this drain-dated October 17, 2007. The report was approved by the Board at the hearing held November 26, 2007. (See Drainage Board Minutes Book 10, Pages 498-499) The changes are as follows:

The 6" SSD was lengthened from 909 feet to 1030 feet.

The length of the drain due to the changes described above is now **1030 feet**.

The non-enforcement was approved by the Board at its meeting on November 26, 2007 and recorded under instrument #2007066458.

The following sureties were guaranteed by Huntington National Bank and released by the Board on its August 13, 2007 meeting.

Bond-LC No: OSB.004528

Insured For: Storm Sewers

Amount: \$120,820.00

Issue Date: June 18, 2007

I recommend the Board approve the drain's construction as complete and acceptable.

Sincerely,

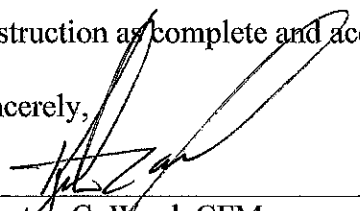
Kenton C. Ward, CFM
Hamilton County Surveyor

KCW/slm

S:\4176055\dwg\C600-Storm Plan & Profile.dwg, Layout1, 11/15/2007 2:49:18 PM, cmliller, 1:1

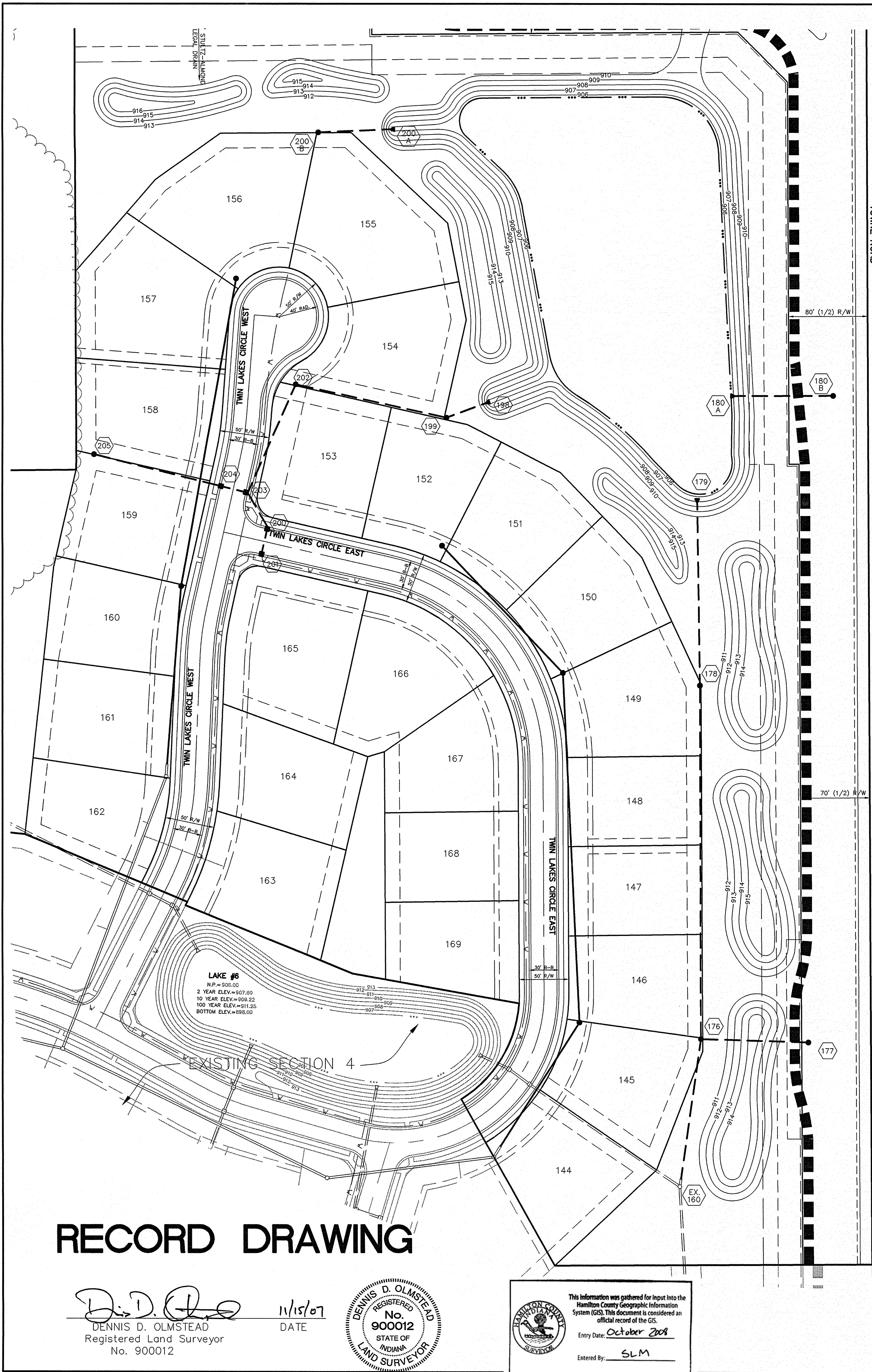

RECORD DRAWING

Dennis D. Olmstead
Registered Land Surveyor
No. 900012

11/15/07
DATE

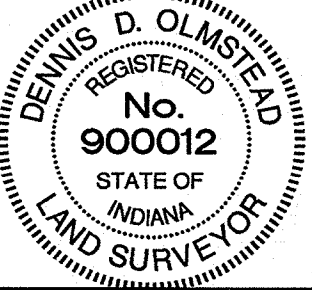

This information was gathered for input into the Hamilton County Geographic Information System (GIS). This document is considered an official record of the GIS.
Entry Date: **October 2008**
Entered By: **SLM**

TONNIE ROAD

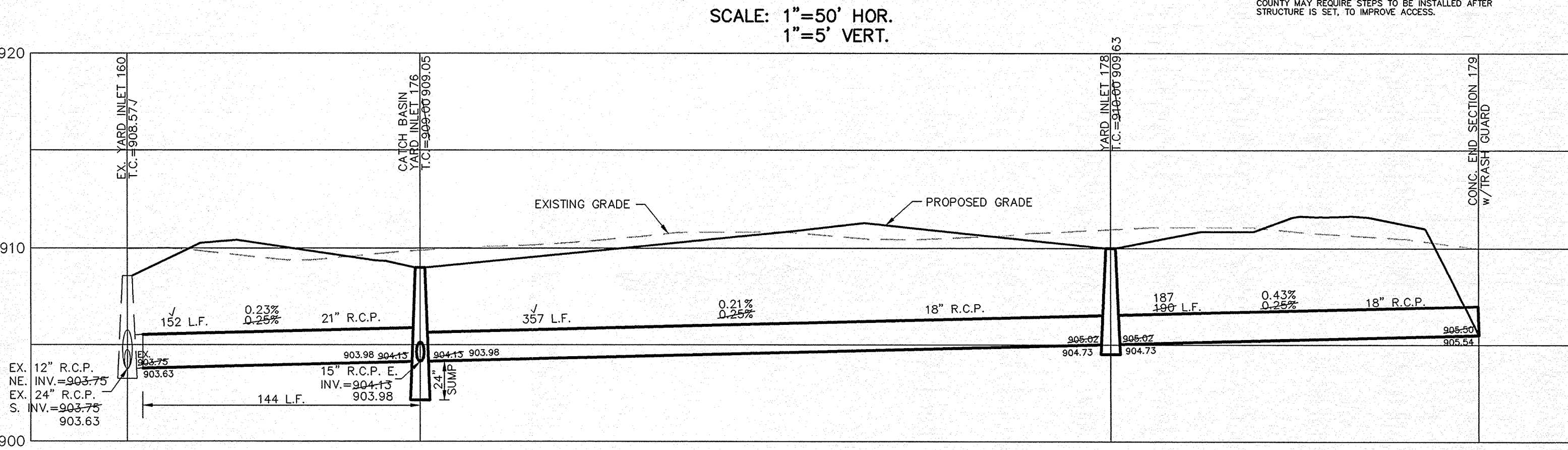
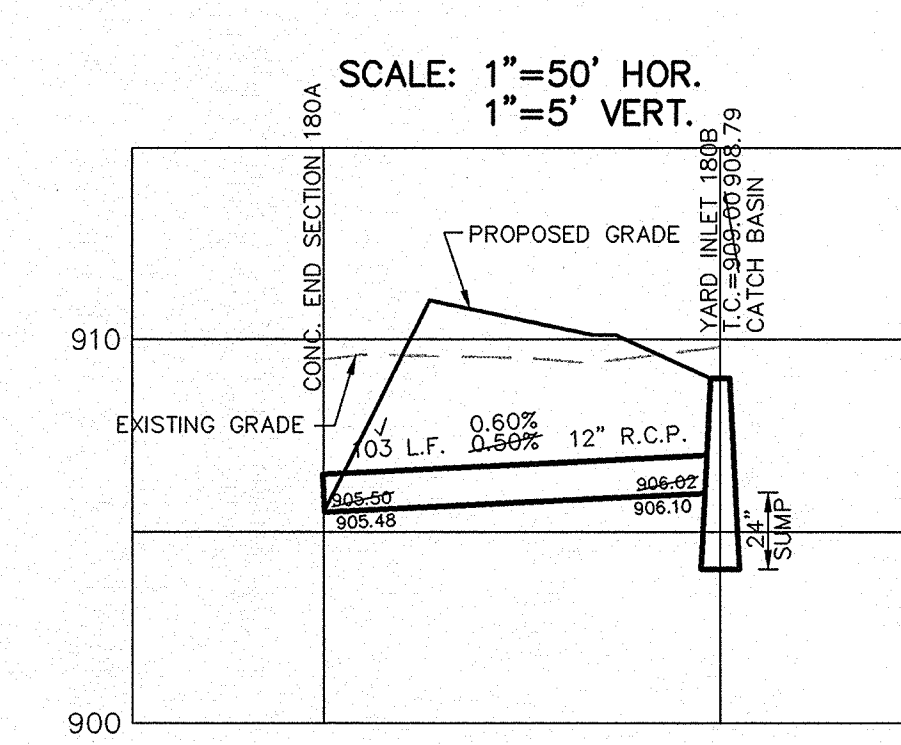
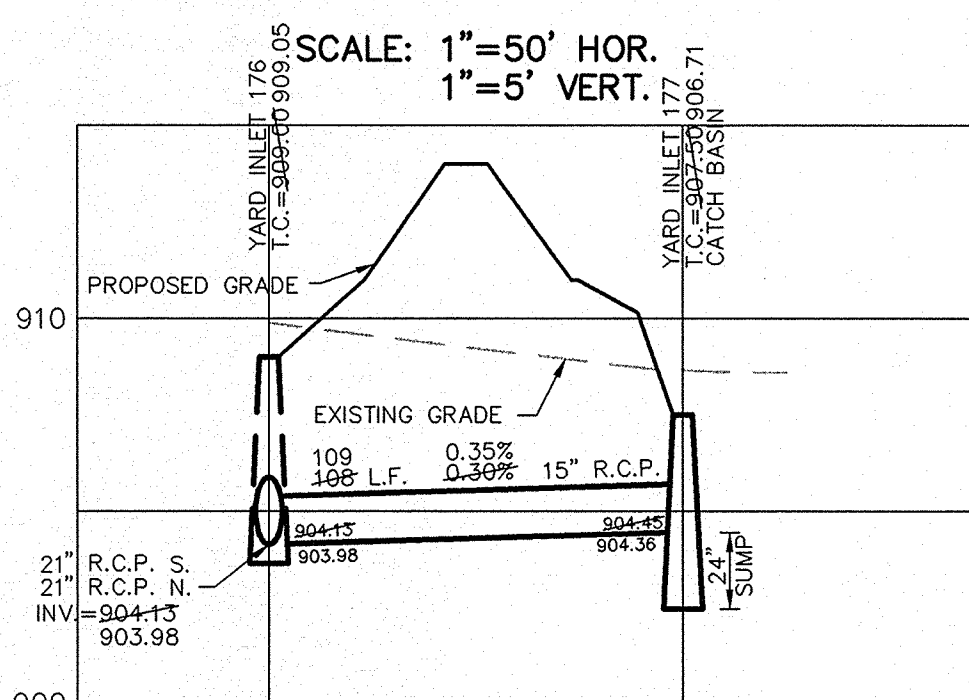
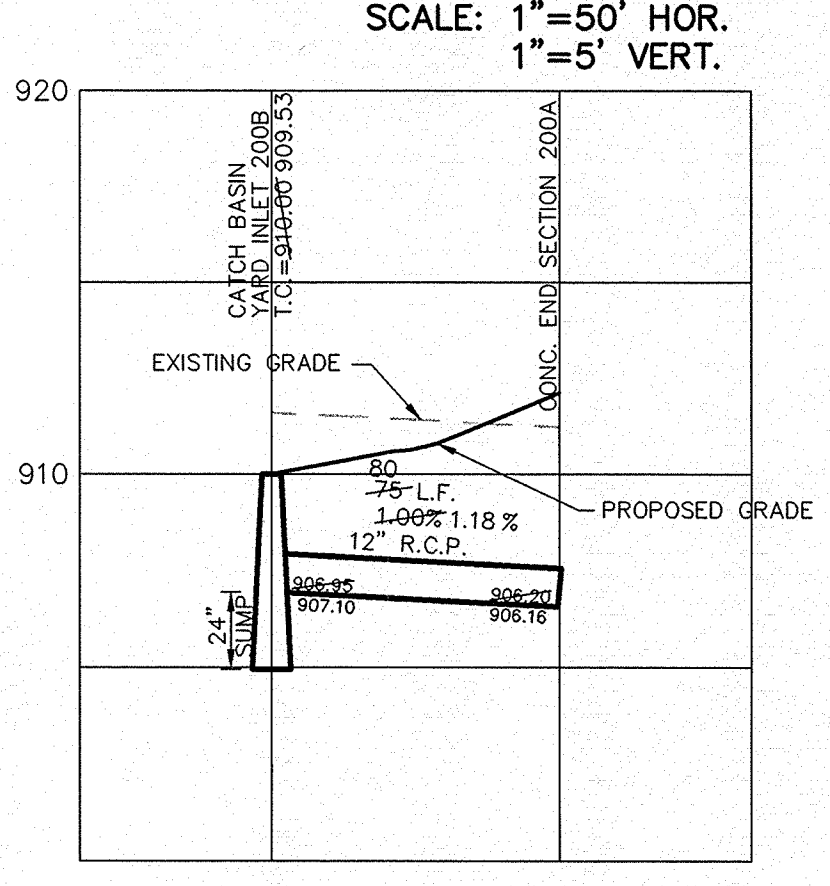
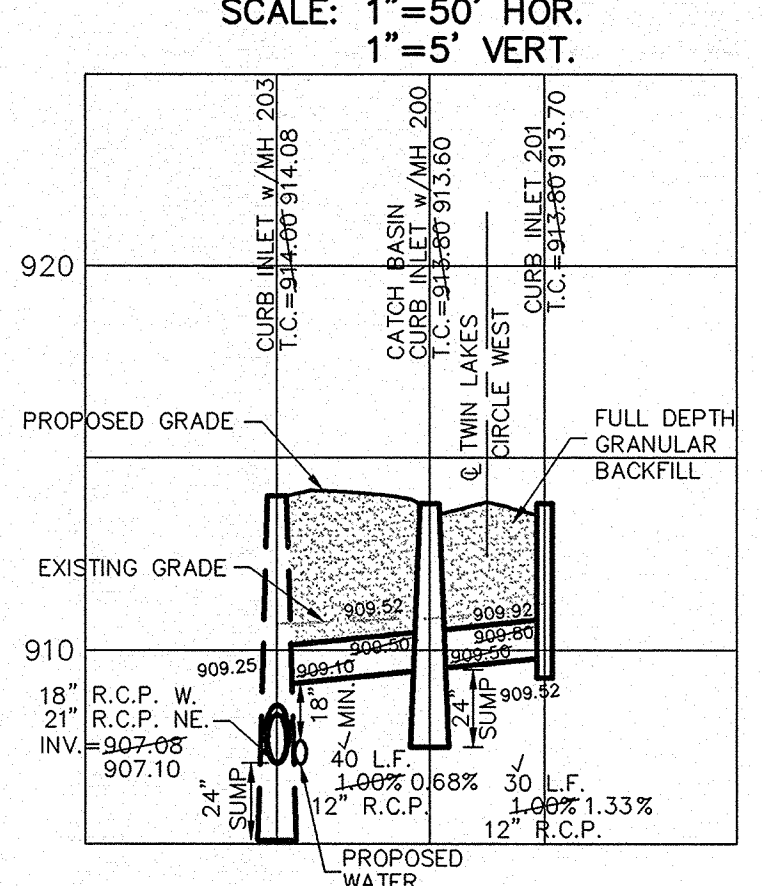
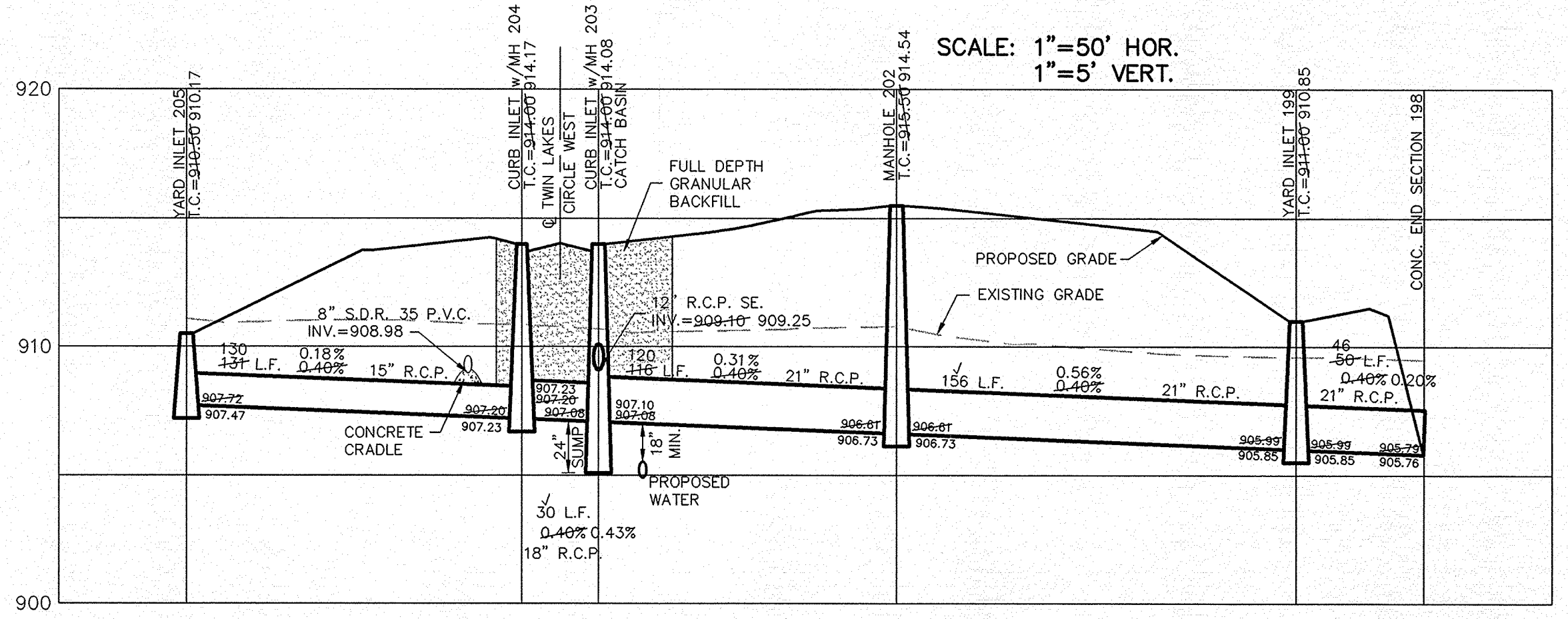

NOTE:
Storm Sewers
Bedding, haunching, and initial backfill for all RCP installations shall be B-Borrow for Structure Backfill meeting the material requirements of the INDOT. Bedding shall be placed in the trench bottom such that after the pipe is installed to grade and line, there remains a 4-inch minimum depth of material below the pipe barrel and a minimum of 3-inches below the bell. For pipe sizes 66-inches and larger, the minimum depth of material below the pipe barrel shall be 6-inches. Bedding shall be placed to be uniform, as possible, but shall be loosely placed uncompacted material under the middle third of the pipe prior to placement of the pipe. Haunching and initial backfill shall be compacted in 8-inch maximum lifts to not less than 90% Standard Proctor Density for the entire depth of the material placed. The backfill shall be brought up evenly on both sides of the pipe for the full length of the pipe. The limit of initial backfill shall be 6-inches above the springline. Minimum trench width shall be the outside diameter of the pipe plus 18-inches.
Final Backfill for all RCP installations under and within 5-feet of pavement shall be B-Borrow for Structure Backfill meeting the material requirement of the INDOT and shall be compacted in 6-inch maximum lifts to not less than 90% Standard Proctor Density for the entire depth of the material placed. The backfill for the top 6-inches of the excavation below the start of the aggregate subbase of the pavement shall be No. 53 Stone meeting the material requirements of the INDOT and shall be compacted to not less than 90% Standard Proctor Density. Final Backfill for all RCP installations greater than 5-feet of pavement shall be clean fill material free of rocks larger than 6-inches in diameter, frozen lumps of soil, wood or other extraneous material, compacted in 12-inch maximum lifts to not less than 90% Standard Proctor Density for the entire depth of the excavation.
S:\Legal\Carmel RCP Installation Review02-01-05\Storm Sewers.doc

ALL EXISTING OFF-SITE DRAIN TILES THAT ARE ENCOUNTERED SHALL BE TIED INTO THE PROPOSED STORM SEWER SYSTEM WITH A POSITIVE OUTFLOW

NOTE:
CONSTRUCTION TOLERANCE FOR YARD INLETS WILL BE +0.0' TO -0.20'

NOTE:
"EXCEPT FOR FORCE MAINS, CONTRACTOR TO INSTALL CONCRETE GRADES WHEN THE VERTICAL SEPARATION (AS MEASURED FROM THE EXTERIOR OF THE PIPES) BETWEEN SANITARY SEWER FACILITIES AND STORM SEWERS IS 18" OR LESS."

ALL STORM SEWER CASTINGS SHALL BE STAMPED "DUMP NO WASTE - DRAINS TO WATERWAY"

THERE SHALL BE NO MANHOLES OR WATER VALVES WITHIN THE STREET PAVEMENTS, CURBS, SIDEWALKS, OR ASPHALT PATHS

NOTE:
FOR INSTALLATION OF STORM MAINS, WATER MAINS, SANITARY MAINS, WATER SERVICE LATERALS, SANITARY SERVICE LATERALS UNDER CITY STREETS, REGARDLESS OF THE JURISDICTION OF THE UTILITY, THE MINIMUM COVER FROM THE TOP OF THE INSTALLED PAVEMENT TO THE TOP OF THE INSTALLED PIPE SHALL BE THE PAVEMENT SECTION THICKNESS (ALL BITUMINOUS AND AGGREGATE MATERIAL ABOVE THE SUBGRADE) PLUS 1'-0". IF THE STANDARD PRACTICE OF THE UTILITY THAT HAS JURISDICTION OVER THE INSTALLATION HAS MORE STRINGENT COVER REQUIREMENT, THE MORE STRINGENT REQUIREMENT SHALL GOVERN.

NOTE:
ALL 24" SUMP CATCH BASIN TO BE 48" MANHOLES PER H.C.S.O.

CURB INLET TABLE

PIPE SIZE	STRUCTURES LESS THAN 48" FROM T/C TO INVERT	STRUCTURES GREATER THAN 48" FROM T/C TO INVERT	ANGLE AND QUALITY OF PIPES WILL REQUIRE SPECIAL DESIGN	STEPS REQUIRED	CURB CASTING *R-3501 N	CASTING *3501 TL & TR
12" to 18"	24"x24"		DESIGN APPROVAL	No	Yes	Yes
12" to 21"	30"x30"		DESIGN APPROVAL	No	Yes	Yes
18" to 21"		MH/BOX	DESIGN APPROVAL	Yes	Yes	Yes
21" to 27"	24"x36"		DESIGN APPROVAL	No	No	Yes
12" to 24"	36"x36"		DESIGN APPROVAL	No	Yes	Yes
24" OR LARGER	DESIGN APPROVAL		DESIGN APPROVAL	No	No	Yes
24" or LARGER		MH/BOX	DESIGN APPROVAL	Yes**	Yes	Yes

* PIPES NO LARGER THAN 18" CAN BE USED IN THE 2' SIDE OF THIS BOX
** INCOMING AND OUT GOING PIPES EFFECT STEPS IN THIS STRUCTURE
SPECIAL NOTE:
STRUCTURES GREATER THAN 48" FROM T/C TO INVERT WILL BE A M.H. OR A BOX WITH STEPS UNLESS SPECIAL DESIGN IS APPROVED.
SPECIAL NOTE:
STRUCTURES WILL BE DESIGNED FOR MAXIMUM FLOW IN PIPES
SPECIAL NOTE:
COUNTY MAY REQUIRE STEPS TO BE INSTALLED AFTER STRUCTURE IS SET, TO IMPROVE ACCESS.

ASBESTOS
11/15/07

REVISED STORM AND PATH
12/04/07

REVISED PER ENGINEER COMMENTS
12/19/08

REV. PIPE SIZE STR. 205-202, 199&198
11/1/08

ADD 2" SUMP TO STR. 177 & 180B
BY

MARK

REVISIONS

DAVID J. STOEPPELWERTH
REGISTERED
No. 19358
STATE OF INDIANA
PROFESSIONAL ENGINEER

CERTIFIED: 9/1/06

David J. Stoepfelwerth

STOEPPELWERTH & ASSOCIATES, INC.
CONSULTING ENGINEERS & LAND SURVEYORS
9940 Allisonville Rd., Fishers, IN 46038-2005
Phone: (317) 849-5935 Fax: (317) 849-5942
Toll Free: (800) 728-6917

INDIANA

STORM PLAN & PROFILES
LAKESIDE PARK
SECTION FIVE

DRAWN BY: BAH
CHECKED BY: EEF

SHEET NO.
C600

S & A JOB NO.
4176055

STR. NO.	TYPE	T.C. / RIM	INVERT	DIRECTION
176	YARD INLET	909.00	904.13	N.S.E
177	YARD INLET	907.50	904.54	W
178	YARD INLET	904.00	905.02	N.S
182	CONC. END SECTION	905.50	905.50	S
183	CONC. END SECTION	905.50	905.50	E
184	YARD INLET	909.00	906.02	W
198	CONC. END SECTION	907.79	907.79	SW
199	CURB INLET	911.00	909.79	NE,NW
200	CURB INLET	913.80	909.14	NW,S
200A	CONC. END SECTION	906.20	906.20	W
200B	YARD INLET	910.00	906.95	SW
201	CURB INLET	913.80	909.80	NW
202	MANHOLE	915.00	906.61	SW,SE
203	CURB INLET w/MH	909.00	909.00	NE,SE,NW
204	CURB INLET w/MH	907.20	907.20	NW,SE
205	YARD INLET	914.00	907.72	SE

BENCHMARKS:

HARRISON MONUMENT FOUND @ 136TH ST. AND TOWNE ROAD.
ELEV.=910.91

HARRISON MONUMENT FOUND @ 141ST ST. AND TOWNE ROAD.
ELEV.=911.36

S&A #1 - R.R.S. SET @ 24" TREE (SOUTH SIDE) 1' UP FROM GROUND,
S.W. CORNER OF WETLANDS @ THE LAKES @ HAYDEN RUN
ELEV.= 915.88

S&A #2 - R.R.S. SET @ WEST SIDE OF TELEPHONE POLE, 3RD POLE
NORTH OF 136TH ST. ON THE EAST SIDE OF TOWNE ROAD
ELEV.= 907.84

S&A #3 - R.R.S. SET @ WEST SIDE P.W.P. #198-293 W/LIGHT @ EAST
SIDE OF TOWNE ROAD AT THE NORTH PROPERTY LINE ADDRESS,
APPROX. 600'± SOUTH OF 141ST STREET.
ELEV.= 912.91

S&A #4 - R.R.S. SET @ SOUTH SIDE OF P.W.P.#838-1623, 4TH POLE
WEST OF TOWNE ON NORTH SIDE OF 141ST STREET.
ELEV.= 913.80

S&A #5 - R.R.S. SET @ SOUTH SIDE OF P.W.P.#838-1629, APPROX. 150'±
WEST OF ADDRESS #2828 ON THE NORTH SIDE OF 141ST STREET.
ELEV.= 915.97

S&A #6 - R.R.S. SET @ SOUTH SIDE OF P.W.P.#838-1635, APPROX. 200'± WEST
OF DRIVEWAY ADDRESS #3121 ON THE NORTH SIDE OF 141ST STREET.
ELEV.= 920.14

S&A #7 - R.R.S. SET @ NORTH SIDE OF A 30" TREE, APPROX. 35'± EAST
OF THE S.W. CORNER OF THE RIDGE AT HAYDEN RUN TRACT ON
THE SOUTH PROPERTY LINE.
ELEV.= 917.99

S&A #8 - R.R.S. SET @ WEST SIDE OF A 18" TREE AT THE S.W. CORNER
OF THE HAMPTONS TRACT OF LAND.
ELEV.= 916.46

TOB=910.0

EMERGENCY OVERFLOW CROSS-SECTION LAKE #5

SCALE: 1"= 50' HOR.
1"= 5' VERT.

ALL PADS SHALL BE TESTED TO ASSURE
A COMPACTION OF AT LEAST 95 PERCENT
OF THE MAXIMUM DRY DENSITY USING THE
STANDARD PROCTOR TEST METHOD.

ALL EXISTING OFF-SITE DRAIN TILES THAT ARE
ENCOUNTERED SHALL BE TIED INTO THE PROPOSED
STORM SEWER SYSTEM WITH A POSITIVE OUTFLOW.
ANY OF THESE TILES WILL NEED TO BE LOCATED,
BREATHERS SET AT THE PROPERTY LINES, CRUSHED
OR REMOVED ACROSS THIS SITE. IF ANY TILES
EXTEND BEYOND THIS SITE, THEY WILL NEED A
POSITIVE OUTLET TO CONTINUE TO FUNCTION.

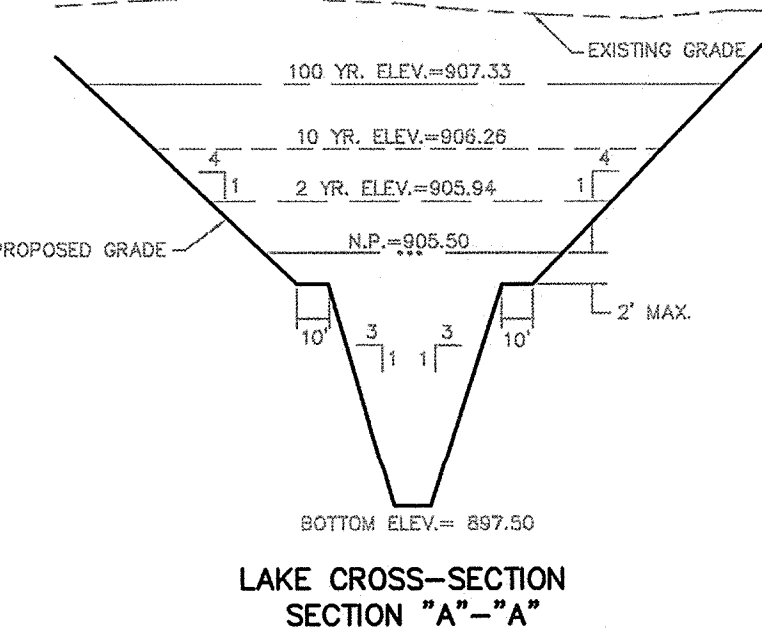

RECORD DRAWING

DENNIS D. OLMSTEAD
Registered Land Surveyor
No. 900012

11/15/07
DATE

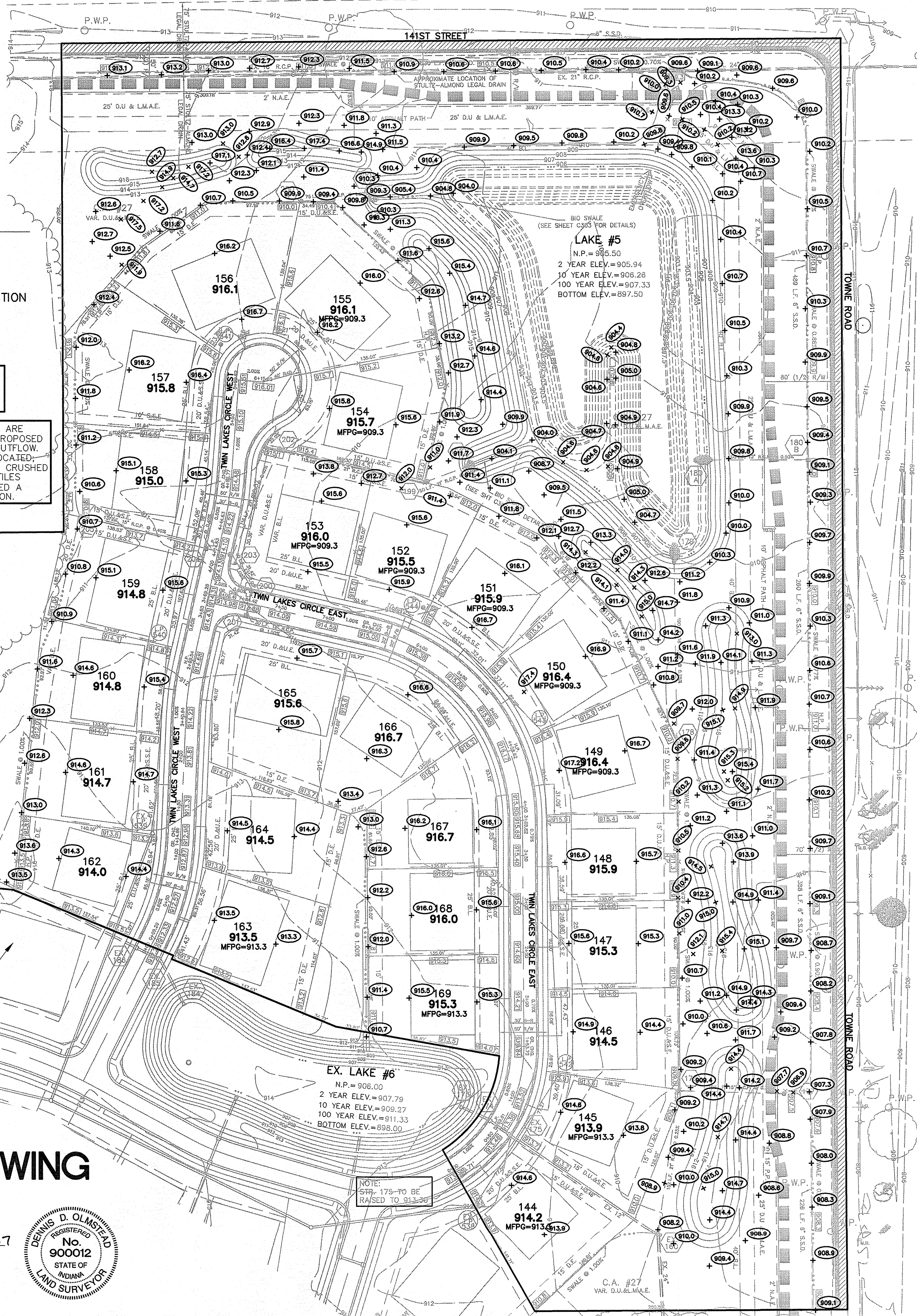

LEGEND

- EXISTING EDGE OF WOODS
- EXISTING CONTOUR
- EXISTING SANITARY SEWER
- EXISTING STORM SEWER
- PROPOSED GRADE
- MATCH EXISTING
- PROPOSED CONTOUR
- PROPOSED SANITARY SEWER
- PROPOSED STORM SEWER
- PROPOSED SWALE
- PROPOSED 5' SIDEWALK (BY HOME BUILDER)
(DEVELOPER SHALL INSTALL SIDEWALKS ALONG ALL COMMON AREAS)
- LOT NUMBER
- PAD ELEVATION
- PAD SIZE: 60'x60'
(UNLESS OTHERWISE NOTED)
- MIN. FLOOD PROTECTION GRADE

- DENOTES 4" SUBSURFACE DRAIN TO LOT
- DENOTES 6" SUBSURFACE DRAIN
- ROLL CURB

NOTE: MIN. FLOOD PROTECTION GRADES OF ALL STRUCTURES FRONTING
POND #2 SHALL BE NO LESS THAN 2 FEET ABOVE ANY ADJACENT
100-YR. LOCAL OR REGIONAL FLOOD ELEVATION (WHICHEVER IS
GREATER FOR ALL WINDOWS, DOORS, PIPE ENTRANCES, WINDOW
WELLS, ETC.)

- DENOTES 1" MILLING WITH 1.5" H.A.C. #11 RESURFACING FOR THE
EXISTING ROADWAY ACROSS THE PROPERTY FRONTAGE AS SHOWN
- DENOTES PAVEMENT WIDENING FOR THE EXISTING
ROADWAY ACROSS THE PROPERTY FRONTAGE AS SHOWN.

ASBUILT GRADE ELEV.

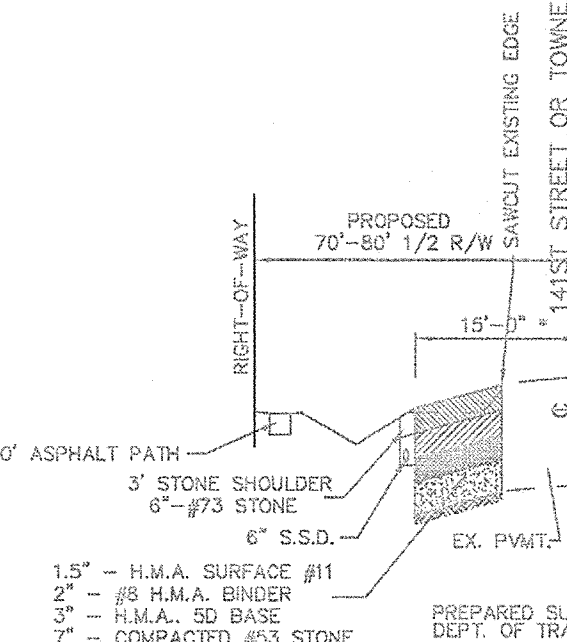

ROAD WIDENING CROSS-SECTION N-T-S.

NOTE
PER HCSO, THERE IS TO BE NO
DRIVEWAY ENCROACHMENTS INTO
EASEMENTS BETWEEN LOTS.

NOTE:
WIDEN SOUTH SIDE OF 141ST STREET AND THE WEST
SIDE OF TOWNE ROAD TO 15'-0" FROM THE EXISTING
CENTER OF PAVEMENT WITH A 3'-0" STONE SHOULDER
ACROSS ENTIRE FRONTAGE. A 6" SSD IS TO BE
INSTALLED UNDER AND ADJACENT TO THE STONE
SHOULDER ALONG 141ST STREET AND TOWNE ROAD.

NOTE TO CONTRACTOR:
CONTRACTOR SHALL VERIFY DEPTHS OF ALL EXISTING
ON-SITE UTILITIES PRIOR TO CONSTRUCTION TO CONFIRM
THERE IS NOT ANY CONFLICTS WITH OTHER UTILITIES,
STORM SEWERS OR STREETS. CONFLICTS AFTER CONSTRUCTION
BEGINNS ARE SOLELY THE CONTRACTOR'S RESPONSIBILITY.

NOTE:
CONTRACTOR SHALL CONTACT THE DEPARTMENT OF ENGINEERING TO
SCHEDULE A PRE-CONSTRUCTION MEETING TO REVIEW THE DEPARTMENT'S
CONSTRUCTION REQUIREMENTS, STAFF NOTIFICATION REQUIREMENTS,
REQUIRED INSPECTIONS FOR CERTAIN STAGES OF THE WORK AND TO
REVIEW THE AUTHORITY OF THE DEPARTMENT AS IT RELATES TO
WORK WITHIN THE EXISTING AND PROPOSED CITY RIGHT-OF-WAY.

"HOLEY MOLEY" SAYS:



1-800-382-5544
CALL TOLL FREE
1-800-428-5200
FOR CALLS OUTSIDE OF INDIANA

CAUTION

LOCATION OF ALL EXISTING UNDERGROUND
UTILITIES SHOWN ON THIS PLAN ARE BASED
UPON ABOVE GROUND EVIDENCE, (including,
but not limited to, manholes, inlets, valves,
and marks made upon the ground by others.) AND
ARE SPECULATIVE IN NATURE. THERE MAY ALSO
BE OTHER EXISTING UNDERGROUND UTILITIES
FOR WHICH THERE IS NO ABOVE GROUND
EVIDENCE OR FOR WHICH NO ABOVE GROUND
EVIDENCE WAS OBSERVED. THE EXACT LOCATIONS
OF SAID EXISTING UNDERGROUND UTILITIES
SHOULD BE VERIFIED BY THE CONTRACTOR
PRIOR TO ANY AND ALL CONSTRUCTION.

CONTACT: CARMEL UTILITIES
(317) 571-2648
FOR WATER LOCATES

MFG	JOH	BAH	BAH	BAH	BY
ASBUILT	REVISED PATH & STORM	REVISED PER ENGINEER COMMENTS	ADD ESMT BETWEEN LOTS 157 & 158	ADD RESURFACING NOTE	REV. PIPE SIZE STR. 2005-2002, 199&188
17/08/07	9/04/07	10/20/07	12/27/06	12/27/06	11/1/06
DATE					REVISIONS
STOEPPELWERTH & ASSOCIATES, INC.					
CONSULTING ENGINEERS & LAND SURVEYORS					
9940 Allisonville Rd., Fishers, IN 46038-2005					
Phone: (317) 849-5935 Fax: (317) 849-5942					
Toll Free: (800) 728-6917					
INDIANA					
SITE DEVELOPMENT PLAN					
LAKESIDE PARK					
SECTION FIVE					
CARMEL					
DRAWN BY: BAH		CHECKED BY: EEF		SHEET NO.	
C200		C200		S & A JOB NO.	
4176055		4176055		4176055	