

SURVEYOR'S OFFICE  
**Hamilton County**

Kenton C. Ward, CFM  
Surveyor of Hamilton County  
Phone (317) 776-8495  
Fax (317) 776-9628

Suite 188  
One Hamilton County Square  
Noblesville, Indiana 46060-2230

**Map Correction-Field Verification**

|                                 |                         |
|---------------------------------|-------------------------|
| Drain Number: #291 Spring Farms | Drain Length: 10,837.52 |
| Drain Name: Spring Farms Sec. 1 | Change +/-: - 116.00    |
| Date: 12/11/07                  | New Length: 10,721.52   |
| Verified By: ORTHO'S & Plans    |                         |

**Notes & Sketch:**

The road improvements done for 13<sup>th</sup> at the Springmill Rd Intersection. The project removed str. 3 and 27' of 12" RCP. Also removed was str. 4 and the pipe between str. 3. Thus, 49' of 12" RCP was removed. At the entrance of Spring Farms Sec. 1, 40' feet of 6" SSD was removed. New structures were set on the existing pipe across Shoemaker Dr. These are noted as str. 15A & 15B on the plans.

Suzanne L. Mills  
GIS Specialist

**+66 STR. #14**

**ADJUST CASTING TO GRADE**

**THOMAS D. HODKIN & CHRISTINA KINSTLER**

**17**

**+66 STR. #12**

**CATCH BASIN TYPE K-10 & 7' OF 12" RCP REQ'D.**

**+66 STR. #13**

**INLET TYPE J-10 & 48' OF 12" RCP REQ'D.**

**PARKS AT SPRING MILL HOMEOWNERS ASSOC.**

**+78 STR. #11**  
**INLET TYPE C-**

**MATCH LINE STA. 103+50**

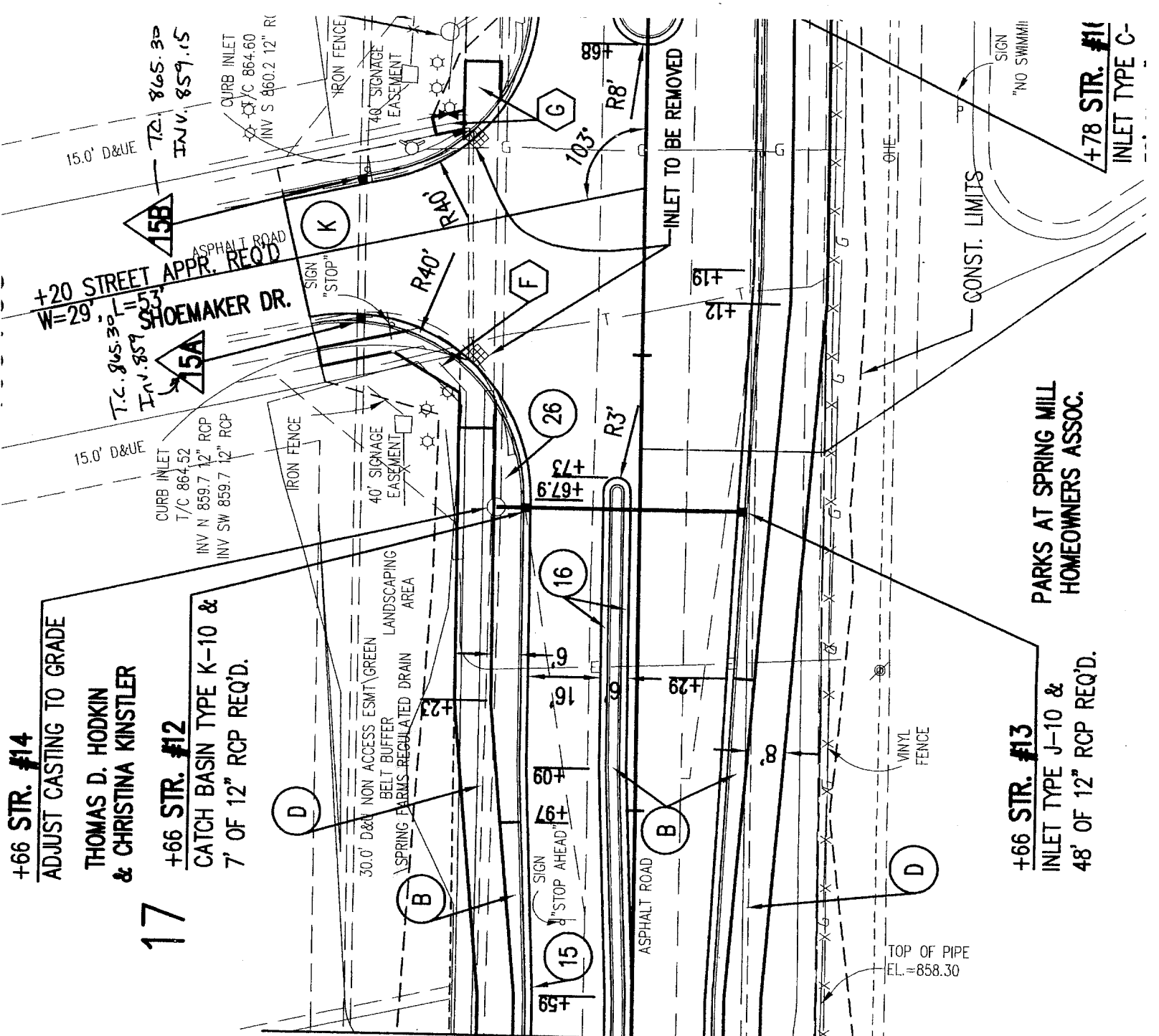

**+20 STREET APPR. REQ'D**  
**W=29', L=53'**  
**T.C. 865.30**  
**I.V. 859**  
**SHOEMAKER DR.**

15.0' D&UE

CURB INLET  
T/C 864.52  
INV N 859.7 12" RCP  
INV SW 859.7 12" RCP

15.0' D&UE  
T.C. 865.30  
I.V. 859.15

ASPHALT ROAD  
SIGN "STOP"

IRON FENCE  
40' SIGNAGE EASEMENT

30.0' D&UE NON ACCESS ESMT GREEN BELT BUFFER LANDSCAPING AREA  
SPRING FARMS REGULATED DRAIN

SIGN "STOP AHEAD"

ASPHALT ROAD

TOP OF PIPE  
EL. = 858.30

VINYL FENCE

CONSTR. LIMITS

SIGN "NO SWIMMING"

INLET TO BE REMOVED