

Drain: William Thomas Drain #: 181
Improvement/Arm: RECONSTRUCTION
Operator: J. LIVINGSTON Date: 7-26-04
Drain Classification: Urban/Rural Year Installed: 1984

GIS Drain Input Checklist

- Pull Source Documents for Scanning
- Digitize & Attribute Tile Drains
- Digitize & Attribute Storm Drains
- Digitize & Attribute SSD
- Digitize & Attribute Open Ditch
- Stamp Plans
- Sum drain lengths & Validate
- Enter Improvements into Posse
- Enter Drain Age into Posse
- Sum drain length for Watershed in Posse
- Check Database entries for errors

[Handwritten signature]
[Handwritten signature]
[Handwritten signature]
[Handwritten signature]
[Handwritten signature]
[Handwritten signature]
[Handwritten signature]
[Handwritten signature]
[Handwritten signature]
[Handwritten signature]

Gasb 34 Footages for Historical Cost
Drain Length Log

Drain-Improvement: WILLIAM THOMAS - RECONSTRUCTION

[illegible]

Sum: $\frac{4445'}{\quad} \frac{4555'}{\quad} \frac{*+110'}{\quad} \frac{\$19,061^{00}}{\quad}$
 $\frac{-575'}{\quad}$ // dividend
3980'

Final Report: _____

Comments:

* LENGTH ON INITIAL REPORT = 1490'. LENGTH AS MEASURED IN THE GIS = 1600'. LENGTH OF OPEN DITCH AS MEASURED IN GIS WAS USED.



SURVEYOR'S OFFICE
Hamilton County

Kenton C. Ward, Surveyor

776-9626

Noblesville, Ind. 46060 July 2, 1984

TO: Hamilton County Drainage Board

RE: William Thomas Drain

Attached are reconstruction plans and an assessment roll for the above named drain. The reconstruction amounts to installing a new ten (10") inch Arm to the drain. Repairing and relocating a portion of the twenty (20") inch tile of the main ditch, rerouting a swale and constructing an open ditch between the Symond's Drain and Eagletown Road where the twenty (20") inch tile no longer functions properly. The cost estimate for the above is as follows.

1280'	10" Conc Tile	@ \$6.35/ft	\$ 8,128.00
Breather		\$300.00 each	300.00
Relocate	300' swale	@ \$3.00/ft	900.00
Repair	100' 20" Con Tile	@ \$9.00/ft	900.00
275'	10" Plastic Tile	@ \$4.00/ft	1,100.00
Clearing	1 acre	@ \$1500.00/ac	1,500.00
Rock Chute		\$2500.00 each	2,500.00
Relocate	20" Tile 60ft.	@ \$9.00/ft	540.00
20'	24" CMP	@ \$22.00/ft	440.00
24"	Animal Guard	@ \$80.00 each	80.00
1490'	Dredging	@ \$3.00/ft	4,470.00
Seeding	7Acres	@ \$300.00/ac	2,100.00
			<hr/>
			\$22,958.00
		plus 10% Cont.	2,295.80
		TOTAL	<hr/>
			\$25,253.80

Upon considering the benefits revealed by each tract in the drainage shed, I believe the benefits for each tract to be equal. The cost per acre will be \$31.50 with a \$100.00 minimum.

The new arm mentioned above will be Arm #3 of the Thomas Drain. This arm was requested by petition last October. See attached petition. A description of this arm is as follows: Beginning

This 940 feet west of the South East corner of the South West quarter of

Section 21 Twp 20 Range # E, thence Southerly 1280 feet to a point approximately 600 feet West and 1060 feet South of aforesaid corner.

Also another Arm as requested by Larue Wallace should be added. It is to be Arm #4 of the Thomas Drain and is described as follows: Beginning approximately 1000 feet North of the South East Corner of the North East Quarter of Section 29, Twp 20 N, Range 3E, thence running in a general North East direction to a point where the tile intersects the main ditch at approximately 1550 feet North and 900 ft East of the aforementioned corner. This arm is approximately 1100 feet in length. I believe the tile to be either eight (8") or (10") ten inch tile.

This drain is presently under maintenance. I recommend a hearing be set for September 10, 1984 at 9:20AM. I also recommend that bids be taken in November 1984 and that construction not commence until April 1, 1985.

KCW/no

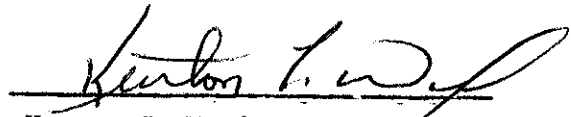
Kenton C. Ward-County Surveyor

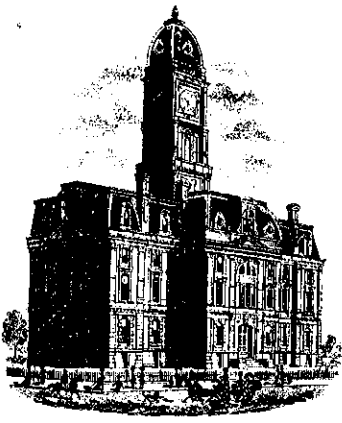

Kenton C. Ward, Surveyor

776-9626

Noblesville, Ind. 46060 July 10, 198⁵

TO: Hamilton County Drainage Board

RE: William Thomas Drain

On June 6, 1985 I made the final inspection on the reconstruction of the William Thomas Drain done by Ron Taylor Excavating, Inc. At this time I found the work to be complete and acceptable.

Extra work involved on this drain amounted to the following:

1. Sediment Trap
2. Rip Rap four corners
3. Outlet a portion of the old tile
4. Two flared inlets
5. 150ft waterway
6. Repair holes in tile.

The total for this work is \$3971.00.

Along with the additional work some work was ordered. This was done at Eagletown Road, where the tile empties into the open ditch. The structure under the road was larger than believed and when the open ditch was brought up to it, changes were needed. The 60 feet of 20 inch tile was omitted, along with the design for the rock chute. The price was reduced \$600.00, because of the tile, but the Rip Rap placed was one at that price.

The total contract price was \$15,690.00. Minus \$600.00 for the tile, plus \$3971.00 for extra work, the total price amounts to \$19,061.00. The estimate for the project was \$25,253.80.

Claims have been paid for the extra work and 85% of the contract price. A claim has been submitted for the 15% retainer, along with a statement that

all expenses has been paid.

I recommend that the Board accept the work as complete and approve the claim.

KCW/no

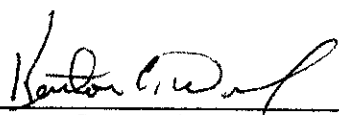
Kenton C. Ward-County Surveyor

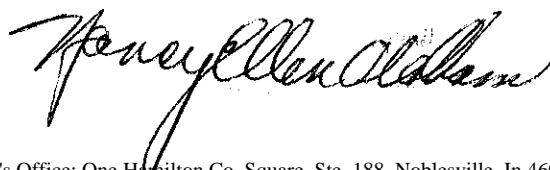

PLAN	DATE	BY
	SURVEYED	BY
	NOTE BOOK	NO.
	RE. OF WAY CHECKED	NO.

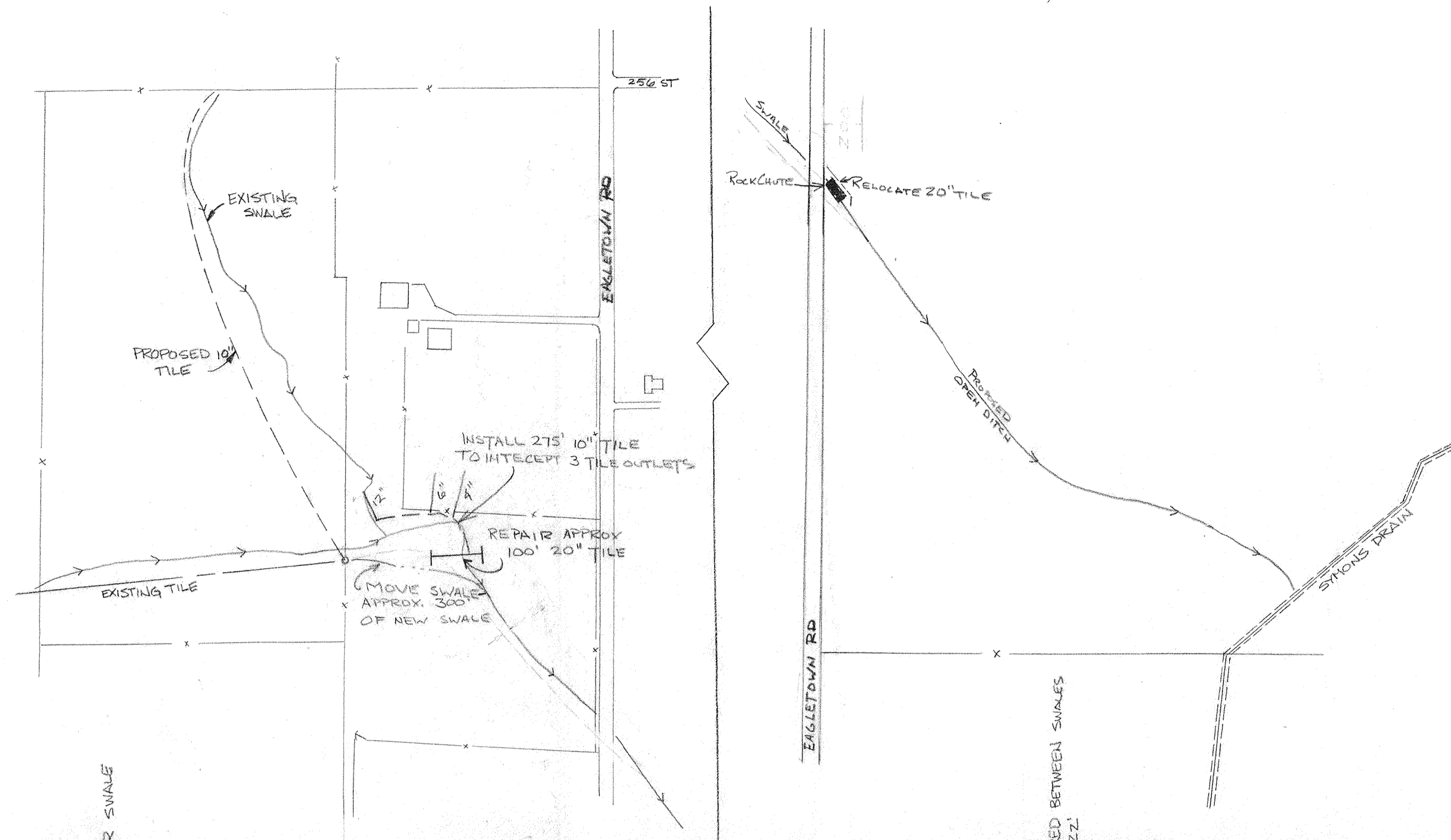

	This information was gathered for input into the Hamilton County Geographical Information System. This document is considered an official record of the GIS.
	Entry Date: <u>7-26-04</u> Entered by: <u>[Signature]</u>

PROFILE	DATE	BY
	SURVEYED	BY
	NOTE BOOK	NO.
	RE. OF WAY CHECKED	NO.

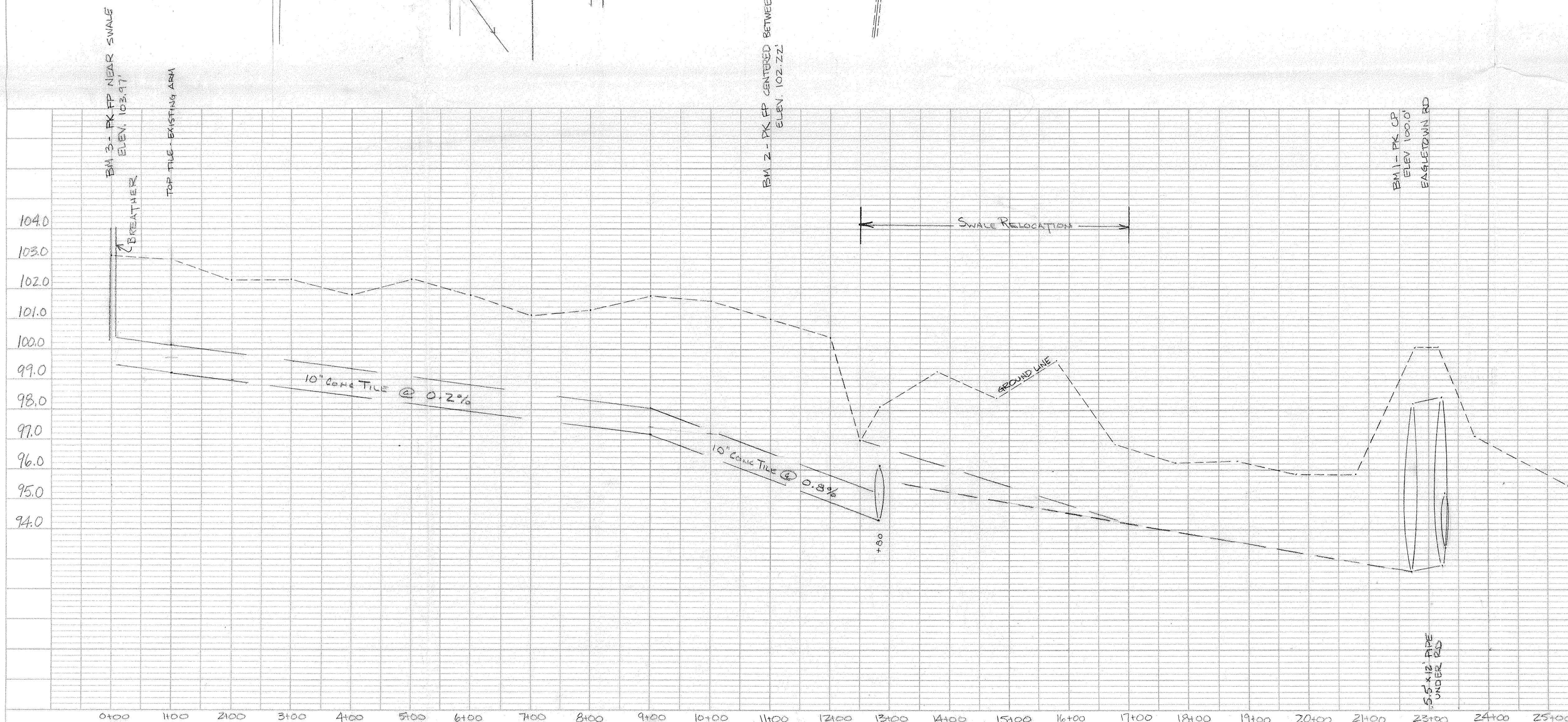

WILLIAM THOMAS