

SURVEYOR'S OFFICE
Hamilton County

Kenton C. Ward, Surveyor

~~776-9626~~ 776-8495

One Hamilton County Square, Ste. 146

~~942~~ *Maple Avenue*

Noblesville, Indiana 46060 September 21, 1992

TO: Hamilton County Drainage Board

RE: Bartholomew Irwin Drain

Attached is a petition and plan for the proposed reconstruction of the Bartholomew Irwin Drain. Industrial Development International (Polygram Records) proposes to relocate a portion of the existing open ditch across their site into a twenty-four (24") inch RCP which will outlet onto the same site.

The new tile drain will consist of 173 feet of pipe replacing approximately the same length of open ditch. The cost of the project **will be paid by the Petitioner.**

I recommend the Drainage Board set a hearing for November 1992 meeting.

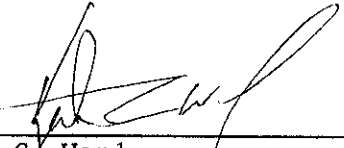

Kenton C. Ward
Hamilton County Surveyor

KCW/no



SURVEYOR'S OFFICE
Hamilton County

Kenton C. Ward, Surveyor

Phone (317) 776-8495

Fax (317) 776-9628

Suite 146

One Hamilton County Square

Noblesville, Indiana 46060-2230

To: Hamilton County Drainage Board

June 11, 1997

**Re: Bartholomew Irwin Drain-
Industrial Development International
(Polygram Records) Relocation**

Attached are as-builts, certificate of completion & compliance, and other information for Industrial Development International. An inspection of the drainage facilities for this section has been made and the facilities were found to be complete and acceptable.

During construction of the drain there were not any significant changes made to the drain. Subsequently, there were not any significant changes made to the plans submitted with my report dated September 21, 1992. Therefore, the length of the drain reconstruction remains at **173 feet** with no additional net gain in length.

A non-enforcement was approved by the Board at its meeting on December 21, 1992 for parcel #19-11-32-00-00-035.001 and recorded under instrument #9300003.

The bond or letter of credit from Industrial Development International was not required. All costs for the relocation were paid for by the petitioner.

I recommend the Board approve the drains construction as complete and acceptable.

Sincerely,

Kenton C. Ward,
Hamilton County Surveyor

KCW/slm



WEIHE ENGINEERS, INC.

Civil Engineers
Land Surveyors
Land Planners

ALLAN H. WEIHE, P.E., L.S.
PRESIDENT

MICHAEL L. DEBOY, L.S.
VICE PRESIDENT

FILED

FEB 18 1994

OFFICE OF HAMILTON COUNTY SURVEYOR

BARTHOLOMEW IRWIN DRAIN

February 17, 1994

Hamilton County Surveyor's Office
ATTN: Mr. Jerry Liston Suite 146
Hamilton County Government Center
One Hamilton County Square
Noblesville, Indiana 46060-2230

RE: Polygram Tract Legal Drain

Dear Jerry,

Enclosed find a "Record Drawing" of the legal drain which runs across the entrance street of the Polygram site for your records. Please call if you have any questions or comments pertaining to this tracing.

Sincerely,

Dave Barnes
Weihe Engineers, Inc.

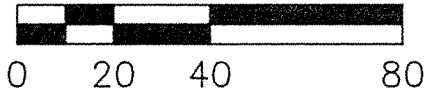

GRAPHIC SCALE

SCALE: 1" = 40'

"RECORD DRAWING" Storm Sewer Line "E-E"
T.C.'s, Inverts, Grades

Allan H. Weihe 2/17/94
ALLAN H. WEIHE, Reg. P.E., INDIANA #8827

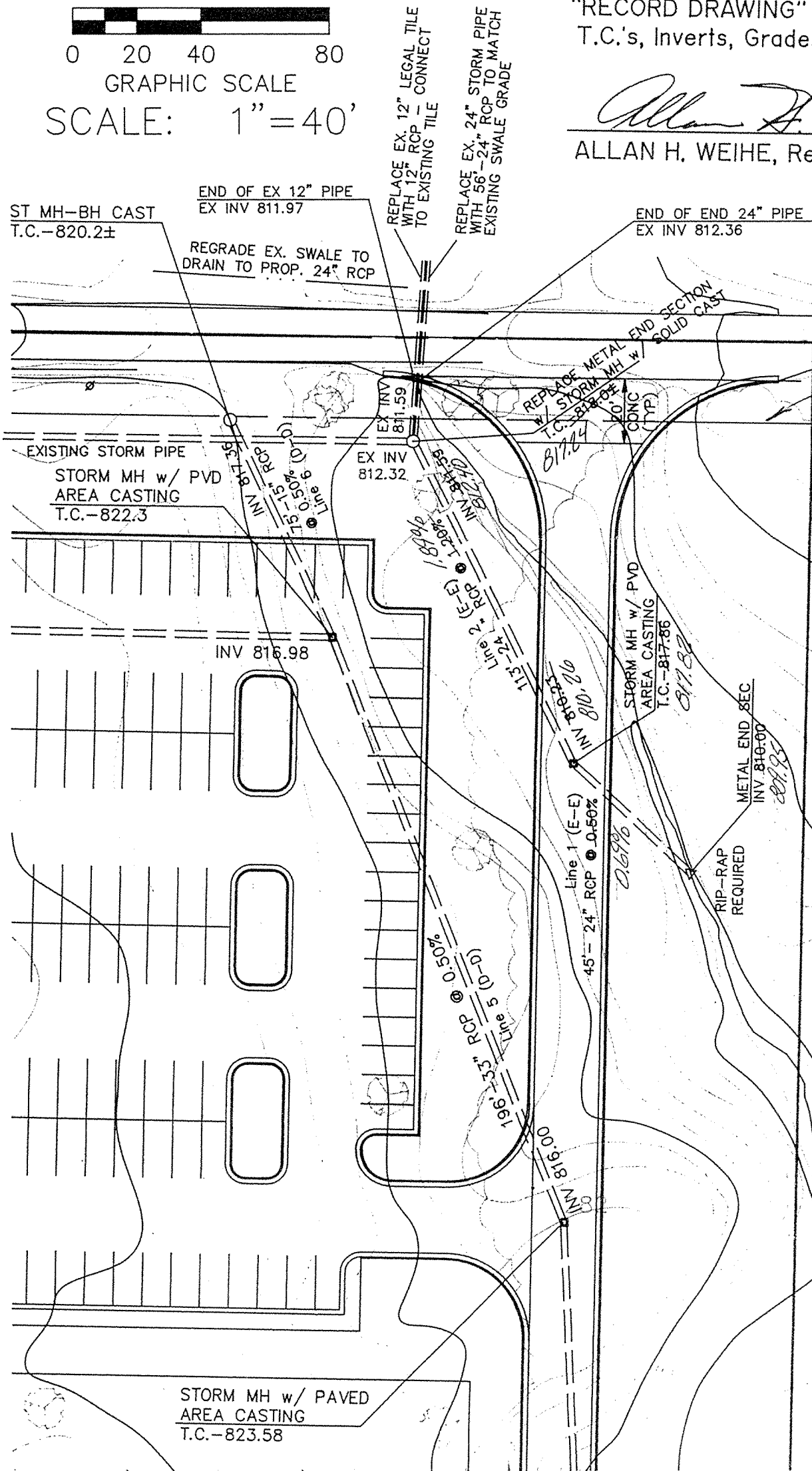

25 RW

This information was gathered for input into the Hamilton County Geographical Information System. This document is considered an official record of the GIS.

Entry Date: 7-29-00
Entered by: S/k

