

Drain: CLARA KNOTTS Drain #: 210  
Improvement/Arm: US 31 IMPROVEMENT  
Operator: J. LIVINGSTON Date: 2-23-04  
Drain Classification: Urban/Rural Year Installed: 1991

### GIS Drain Input Checklist

- Pull Source Documents for Scanning JL
- Digitize & Attribute Tile Drains \_\_\_\_\_
- Digitize & Attribute Storm Drains JL
- Digitize & Attribute SSD \_\_\_\_\_
- Digitize & Attribute Open Ditch \_\_\_\_\_
- Stamp Plans JL
- Sum drain lengths & Validate \_\_\_\_\_
- Enter Improvements into Posse \_\_\_\_\_
- Enter Drain Age into Posse \_\_\_\_\_
- Sum drain length for Watershed in Posse \_\_\_\_\_
- Check Database entries for errors \_\_\_\_\_

**Gasb 34 Footages for Historical Cost  
Drain Length Log**

Drain-Improvement: CLARA KNOTTS - US 31 IMPROVEMENT

Drain Type:	Size:	Length AS BUILTS	Length (DB Query)	Length Reconcile	If Applicable	
					Price:	Cost:
RCP	12"	524'	524'		7.25/lf	3799. <sup>00</sup>
	15"	278'	278'		9. <sup>50</sup> /lf	2641. <sup>00</sup>
	18"	211'	211'		10. <sup>50</sup> /lf	2215. <sup>50</sup>

Sum: 1013'     1013'     \$18655.<sup>50</sup>

Final Report: \_\_\_\_\_

Comments:  
 \_\_\_\_\_  
 \_\_\_\_\_  
 \_\_\_\_\_  
 \_\_\_\_\_  
 \_\_\_\_\_



SURVEYOR'S OFFICE  
**Hamilton County**

*Kenton C. Ward, Surveyor*

*Phone (317) 776-8495*

*Fax (317) 776-9628*

*Suite 146*

*One Hamilton County Square*

*Noblesville, Indiana 46060-2230*

To: Hamilton County Drainage Board

January 23, 1998

**Re: Clara Knotts Drain: US 31 Improv.**

Attached is information for the US 31 improvements made to the Clara Knotts Drain. An inspection of the drainage facilities for this section has been made and the facilities were found to be complete and acceptable.

The Indiana Department of Transportation replaced the existing legal drain along 96<sup>th</sup> St. between Pennsylvania and US 31. The pipe was upsized from 15" RCP to 18" RCP. The drain was not significantly changed other than the deletion of a small portion of drain at the US 31 intersection. This relocation resulted in a reduction in the net length of drain by **95' feet**.

All work was done within the existing right of way for 96<sup>th</sup> Street and US 31.

All costs were incurred by the state. Therefore, a bond or letter of credit was not required.

I recommend the Board approve the drains construction as complete and acceptable.

Sincerely,

Kenton C. Ward,  
Hamilton County Surveyor

KCW/slm

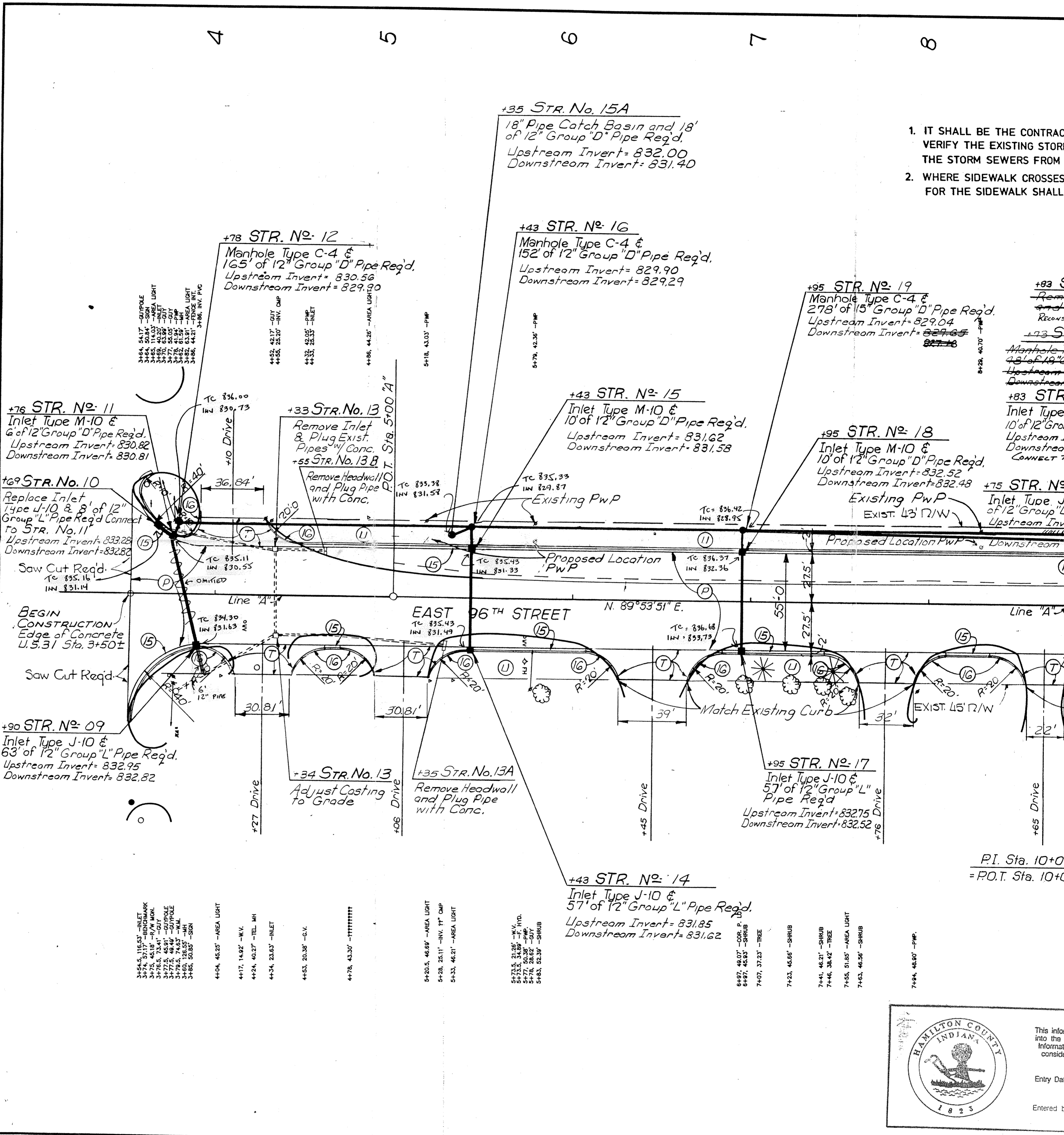

1. IT SHALL BE THE CONTRACTOR'S RESPONSIBILITY TO VERIFY THE EXISTING STORM SEWER LINES AND THE STORM SEWERS FROM THIS PROJECT.
2. WHERE SIDEWALK CROSSES OVER A STORM SEWER, THE SIDEWALK SHALL BE CONSTRUCTED OVER THE SEWER.

**+83 STR. No. 17**  
 Inlet Type J-10 & 57' of 12" Group "L" Pipe Req'd.  
 Upstream Invert = 832.75  
 Downstream Invert = 832.52

**+75 STR. No. 18**  
 Inlet Type J-10 & 57' of 12" Group "L" Pipe Req'd.  
 Upstream Invert = 832.75  
 Downstream Invert = 832.52

**+95 STR. No. 17**  
 Inlet Type J-10 & 57' of 12" Group "L" Pipe Req'd.  
 Upstream Invert = 832.75  
 Downstream Invert = 832.52

P.I. Sta. 10+00  
 = P.O.T. Sta. 10+00



This information is provided into the H... Informatic... consider  
 Entry Date  
 Entered by

FEDERAL ROAD REGION NO.	STATE	PROJECT NO.	FISCAL YEAR	SHEET NO.	TOTAL SHEETS
5	IND.			ST-9	

AS-BUILT INFORMATION OBTAINED FROM CRIDER & CRIDER INC.

- IT SHALL BE THE CONTRACTORS RESPONSIBILITY TO FIELD VERIFY THE EXISTING STORM SEWERS AND PROTECT THE STORM SEWERS FROM DAMAGE DURING CONSTRUCTION.
- WHERE SIDEWALK CROSSES DRIVEWAYS THE DEPTH OF CONCRETE FOR THE SIDEWALK SHALL BE FIVE (5) INCHES.

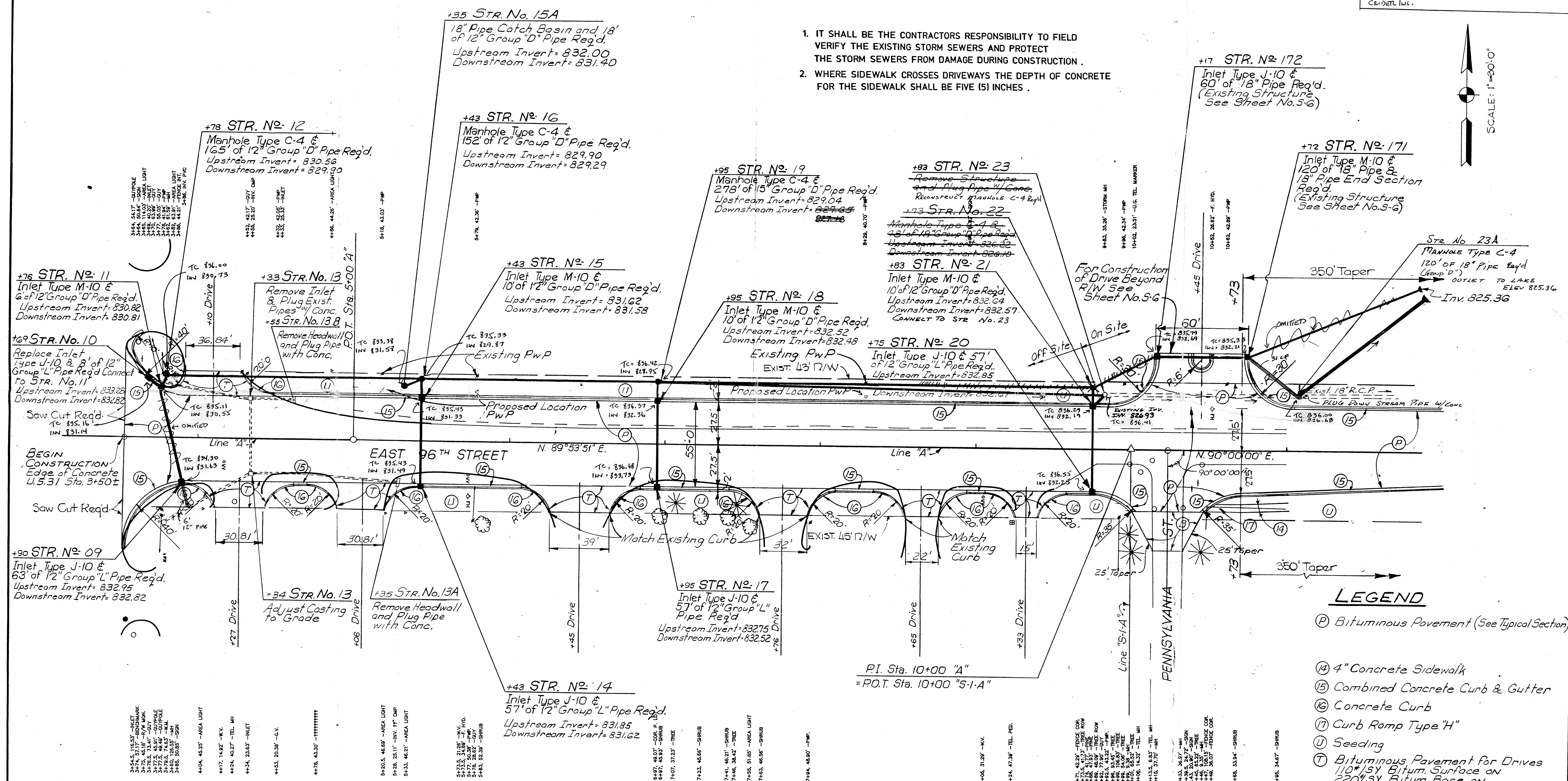
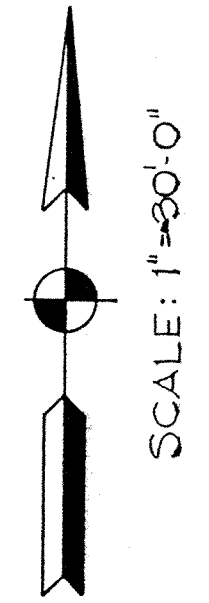

**LEGEND**

- (P) Bituminous Pavement (See Typical Section)
- (4) 4" Concrete Sidewalk
- (5) Combined Concrete Curb & Gutter
- (6) Concrete Curb
- (7) Curb Ramp Type "H"
- (U) Seeding
- (7) Bituminous Pavement for Drives 110#/SY Bitum. Surface on 220#/SY Bitum. Base on 4" type "P" Compacted Aggregate
- (8) Bituminous Patch 110#/SY Bitum. Surface on 275#/SY Bitum. Binder on 440#/SY Bitum. Base #5D

HAMILTON COUNTY INDIANA

This information was gathered for input into the Hamilton County Geographical Information System. This document is considered an official record of the GIS.

Entry Date: 2-23-04

Entered by: *[Signature]*

FILED

JAN 09 1991

OFFICE OF HAMILTON COUNTY SURVEYOR

**DETAILS**

HERBERT T. AYERS  
PROFESSIONAL ENGINEER